

TECHNICAL DATA SHEET

ERLAWA900BB Brushed Brass Bath Waste & Overflow

Barcode	7427042693923
Product Code	ERLAWA900BB
Construction	Brass, Stainless steel, Polypropylene & ABS
Finishes	Brushed Brass
Product Type	Contemporary
Water Pressure	Min. 0.2 bar, Max. 5.0 bar
Plumbing Systems	Suitable for all plumbing systems
Standards	-
Certification	-
Fitting	Polypropylene G1-1/2" BSP Male thread
Packaging	60 x 47 x 42.5cm / carton (20 boxes), Dimension: 45 x 14.5 x 8cm / box; Weight: 0.66Kg / box
Guarantee	1 year against manufacturing faults (excluding serviceable parts)
Additional Information	Centre to centre length: 980mm, suitable for Bathtub with 5-15mm thickness

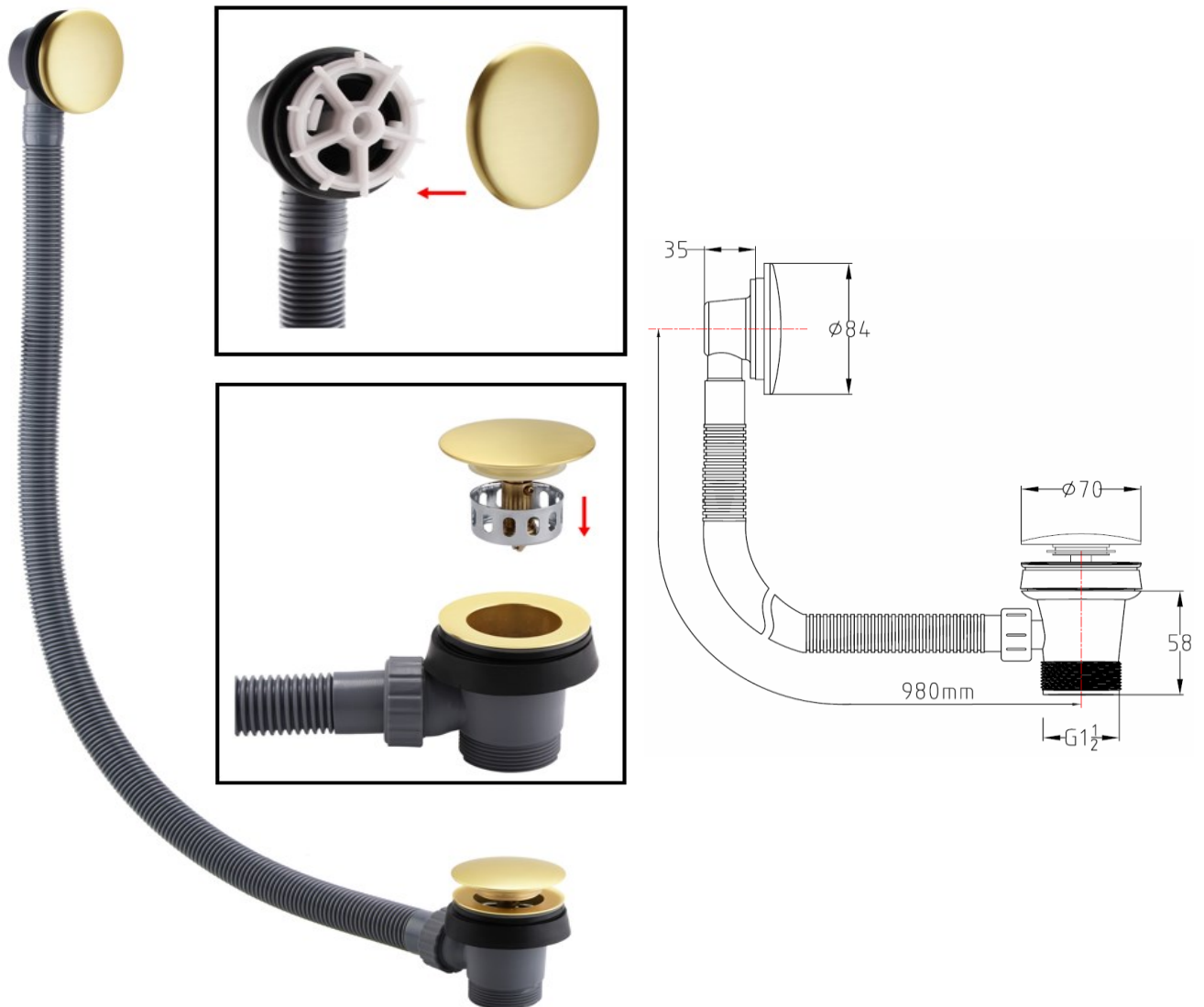

Flow Rates (Litres per minute)

System Pressure	0.1 Bar	0.2 Bar	0.3 Bar	0.5 Bar	1.0 Bar	1.5 Bar	2.0 Bar	3.0 Bar	4.0 Bar	5.0 Bar
WA900E BB	-	-	-	-	-	-	-	-	-	-

The information contained on this page was correct at date of issue. Fitting dimensions are provided as a guide only. Some variation may occur due to manufacturing tolerances. We pursue a policy of continuing improvement in design and performance of our products and so reserve the right to change specifications without prior notice.